

Awning

SECTION NUMBER	DESCRIPTION	MASS kg/m	OUTSIDE PERIM	LENGTH	STOCKED IN ANODISED
6595	AWNING TRACK	0.221	95.94	5.00	✓
33601	AWNING TRACK	0.194	103.12	6.00	
34987	AWNING TRACK	0.496	192.36	5.00	
35469	AWNING TRACK	0.561	160.02	5.00	
35511	AWNING FRAME	0.382	125.94	6.00	
35512	2 WAY AWNING FRAME	0.708	211.83	6.00	
34049	ROLLER TUBE	1.253	256.29	6.00	
8955	ROPE TRACK	0.279	129.99	5.00	
TU8240	EXTRUDED TUBE	0.251	62.80	5.00	BRIGHT ANODISED
TU8575	EXTRUDED TUBE	0.562	78.50	5.00	BRIGHT ANODISED

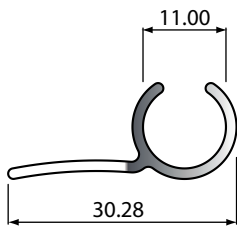

SECTION No. 33601
0.194 kg/m
P = 103.12

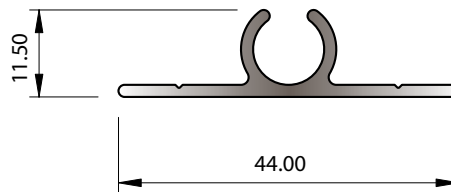

SECTION No. 8955
0.279 kg/m
P = 129.99

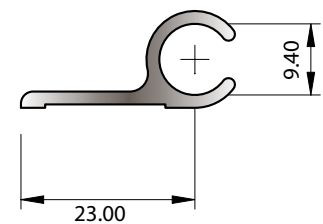

SECTION No. 6595
0.221 kg/m
P = 95.94

For NZ based customers. All lengths are stocked in 6060 T5 - mill finish - 5m lengths (unless specified)
All peripheries less than 100mm are deemed 100mm for surface finish purpose

Awning

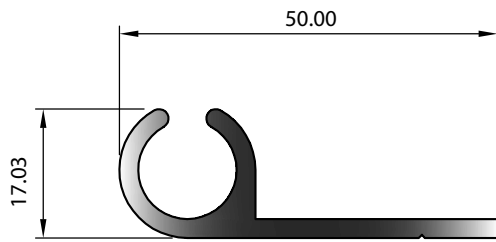

SECTION No. 35469
0.561 kg/m
P = 160.02

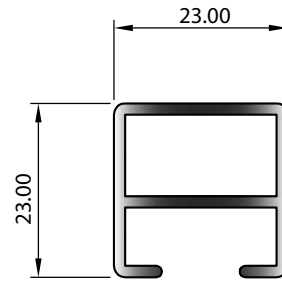

SECTION No. 35511
0.382 kg/m
P = 125.94

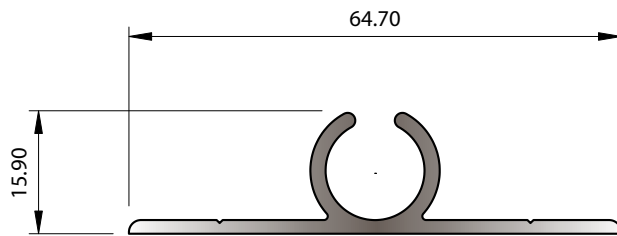

SECTION No. 34987
0.496 kg/m
P = 192.36

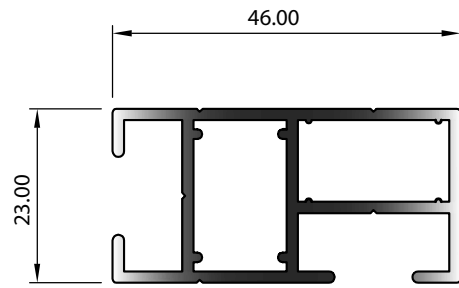

SECTION No. 35512
0.708 kg/m
P = 211.83



SECTION No. 34049
1.253 kg/m
P = 256.29

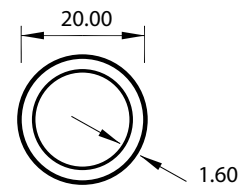

SECTION No. TU8240
0.251 kg/m
P = 62.8

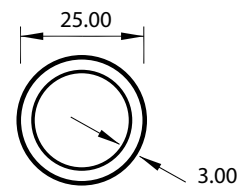

SECTION No. TU8575
0.562 kg/m
P = 78.5

For NZ based customers. All lengths are stocked in 6060 T5 - mill finish - 5m lengths (unless specified)
All peripheries less than 100mm are deemed 100mm for surface finish purpose