

## Miscellaneous

SECTION NUMBER	DESCRIPTION	MASS kg/m	OUTSIDE PERIM	LENGTH	STOCKED IN ANODISED
34050^	MOBILITY THRESHOLD	0.809	304.98	5.00	✓
0330	MOULD	0.342	88.00	5.00	
8966	COLONIAL BAR	0.143	5.00		
35242	LIGHT BOX	1.346	503.49	6.00	
35243	LIGHT BOX	1.850	599.95	6.00	
X540^	SIGN FRAME	1.418	528.89	6.00	
7789	COVING	0.360	118.32	5.00	

^ Stocked in Christchurch warehouse only

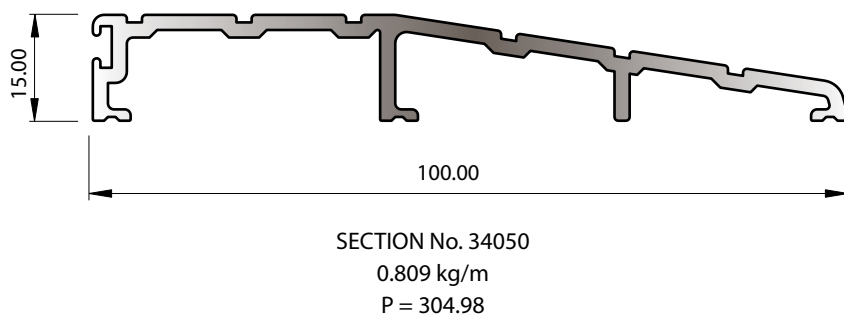
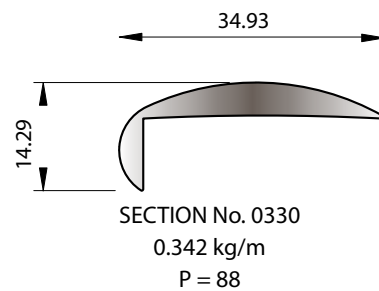
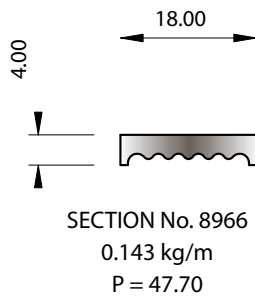

For NZ based customers. All lengths are stocked in 6060 T5 - mill finish - 5m lengths (unless specified)  
All peripheries less than 100mm are deemed 100mm for surface finish purpose

# Miscellaneous

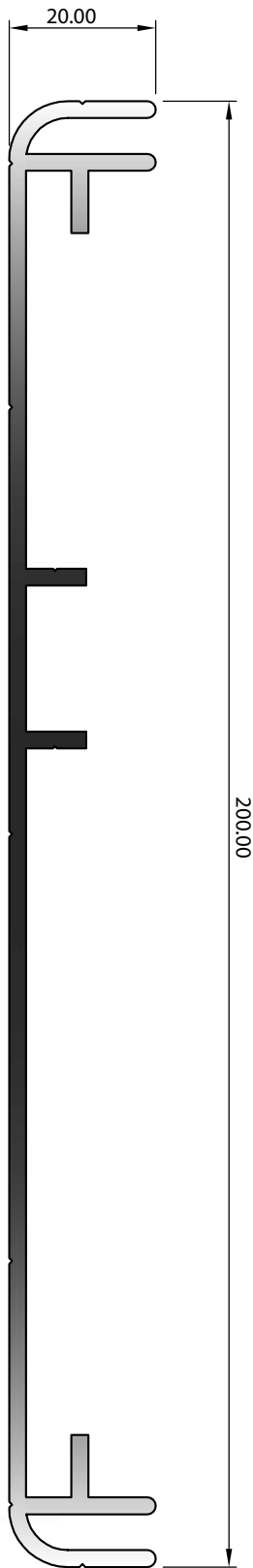

SECTION No. 35243  
 1.850 kg/m  
 P = 599.95

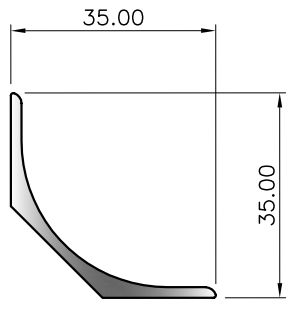

SECTION No. 7789  
 0.360 kg/m  
 P = 118.32

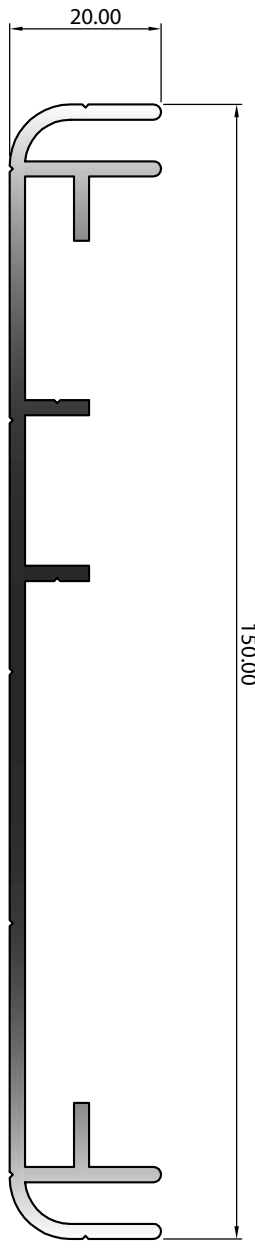

SECTION No. 35242  
 1.346 kg/m  
 P = 503.49

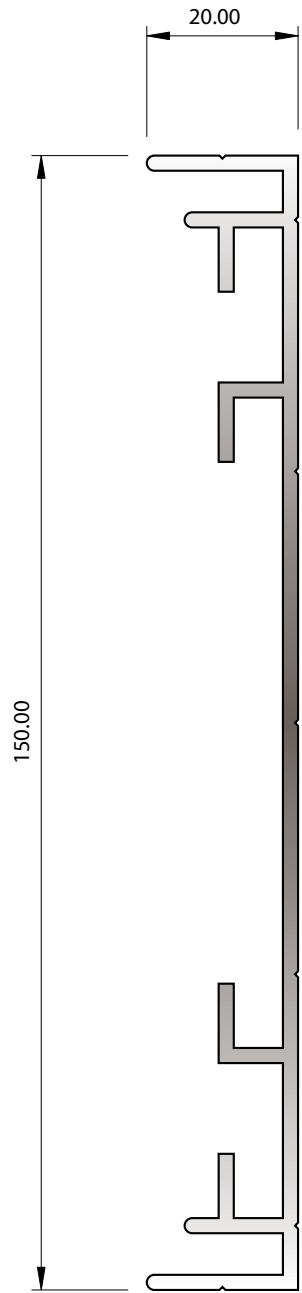

SECTION No. X540  
 1.418 kg/m  
 P = 528.89

For NZ based customers. All lengths are stocked in 6060 T5 - mill finish - 5m lengths (unless specified)  
 All peripheries less than 100mm are deemed 100mm for surface finish purpose